

- FOUNDATION PLAN NOTES:**
1. ALL FOUNDATION WALLS TO BE 16" CONC. WITH 4" REBAR @ 16" O.C.
 2. ALL FOUNDATION WALLS TO BE 16" CONC. WITH 4" REBAR @ 16" O.C.
 3. ALL FOUNDATION WALLS TO BE 16" CONC. WITH 4" REBAR @ 16" O.C.
 4. ALL FOUNDATION WALLS TO BE 16" CONC. WITH 4" REBAR @ 16" O.C.
 5. ALL FOUNDATION WALLS TO BE 16" CONC. WITH 4" REBAR @ 16" O.C.
 6. ALL FOUNDATION WALLS TO BE 16" CONC. WITH 4" REBAR @ 16" O.C.
 7. ALL FOUNDATION WALLS TO BE 16" CONC. WITH 4" REBAR @ 16" O.C.
 8. ALL FOUNDATION WALLS TO BE 16" CONC. WITH 4" REBAR @ 16" O.C.
 9. ALL FOUNDATION WALLS TO BE 16" CONC. WITH 4" REBAR @ 16" O.C.
 10. ALL FOUNDATION WALLS TO BE 16" CONC. WITH 4" REBAR @ 16" O.C.

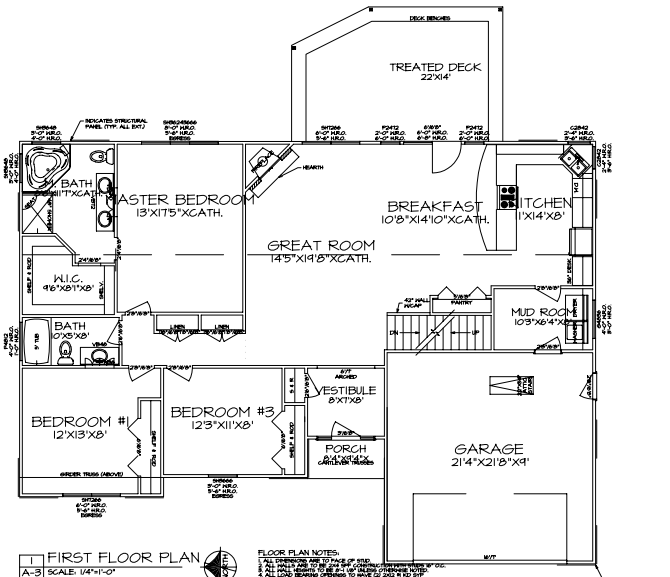

- FIRST FLOOR PLAN NOTES:**
1. ALL INTERIOR WALLS TO BE 5/8" CMU WITH 1/2" GYPSUM BOARD.
 2. ALL INTERIOR WALLS TO BE 5/8" CMU WITH 1/2" GYPSUM BOARD.
 3. ALL INTERIOR WALLS TO BE 5/8" CMU WITH 1/2" GYPSUM BOARD.
 4. ALL INTERIOR WALLS TO BE 5/8" CMU WITH 1/2" GYPSUM BOARD.
 5. ALL INTERIOR WALLS TO BE 5/8" CMU WITH 1/2" GYPSUM BOARD.
 6. ALL INTERIOR WALLS TO BE 5/8" CMU WITH 1/2" GYPSUM BOARD.
 7. ALL INTERIOR WALLS TO BE 5/8" CMU WITH 1/2" GYPSUM BOARD.
 8. ALL INTERIOR WALLS TO BE 5/8" CMU WITH 1/2" GYPSUM BOARD.
 9. ALL INTERIOR WALLS TO BE 5/8" CMU WITH 1/2" GYPSUM BOARD.
 10. ALL INTERIOR WALLS TO BE 5/8" CMU WITH 1/2" GYPSUM BOARD.

STATISTICS:	
AREA:	PROPOSED:
FIRST FLOOR AREA:	1,815 S.F.
SECOND FLOOR AREA:	N/A
TOTAL LIVING AREA:	1,815 S.F.
BASEMENT AREA:	1,820 S.F.
GARAGE AREA:	481 S.F.
TOTAL AREA:	4,116 S.F.

GALLIVAN'S
DRAFTING & DESIGN
(217) 202-5998